

# GRL-2-L

## SINGLE-FLANGED GUIDE ROLLERS (DOUBLE BEARINGS)



**GRL-S2-L**  
(Steel)



**GRL-J2-L**  
(Plastic)

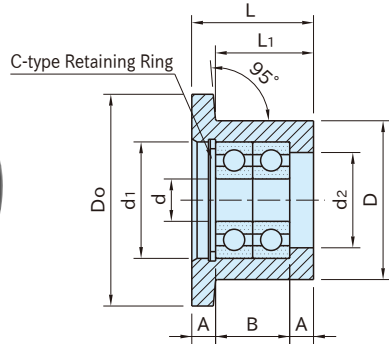

Type	Body	Bearing/Retaining Ring
<b>GRL-S2-L</b>	S45C steel Electroless nickel plated	Steel
<b>GRL-J2-L</b>	Polyacetal plastic Black	

Type	d	D <sub>o</sub>	D	d <sub>1</sub>	d <sub>2</sub>	L	L <sub>1</sub>	A	B	Bearing Type	Applicable Roller Screws	
<b>GRL-S2-L</b>	30	6	30	22	17	13	18	14	3	12	606ZZ×2	RLB0612
	40	8	40	30	22	18	23	18.5	4.5	14	608ZZ×2	RLB0814
<b>GRL-J2-L</b>	50	10	50	36	26	22	27	22.5	5.5	16	6000ZZ×2	RLB1016
	60	12	60	42	32	26	33	28	6.5	20	6201ZZ×2	RLB1220
	70	15	70	46	35	29	39	33.5	8.5	22	6202ZZ×2	RLB1522

Steel		Plastic	
Part Number	Weight (g)	Part Number	Weight (g)
<b>GRL30S2-L</b>	45	<b>GRL30J2-L</b>	20
<b>GRL40S2-L</b>	105	<b>GRL40J2-L</b>	40
<b>GRL50S2-L</b>	180	<b>GRL50J2-L</b>	65
<b>GRL60S2-L</b>	290	-	-
<b>GRL70S2-L</b>	410	-	-

### Features:

- Use as rollers for sliding doors or carriers.
- Heavy-duty
- This product can accept a polished steel bar that is available commercially.

### Related Product Page

Applicable Roller Screws  
**RLB** ROLLER SCREWS

### Technical Information:

#### Load Rating of Bearings

Bearing Type	Basic Load Rating Cr (N)	Basic Static Load Rating Cor (N)
<b>606ZZ×2</b>	3660	1360
<b>608ZZ×2</b>	5340	2200
<b>6000ZZ×2</b>	7370	3190
<b>6201ZZ×2</b>	11010	4940
<b>6202ZZ×2</b>	12390	5990