

MAU3222SS

COMPACT MECHANICAL LINEAR ACTUATORS

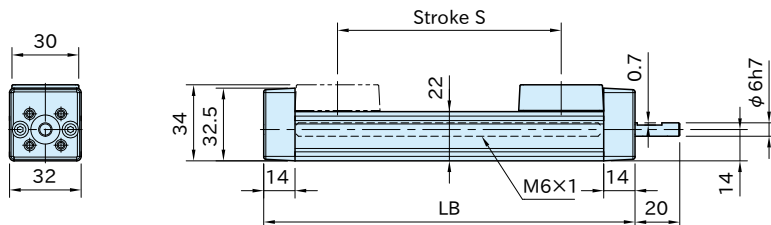

Body	Carriage End Plates	Shaft	Dustproof Sheet
A6N01 aluminum Anodized Natural	Polyamide (glass-fiber reinforced) Black	S45C steel Black oxide finish	SUS304 stainless steel

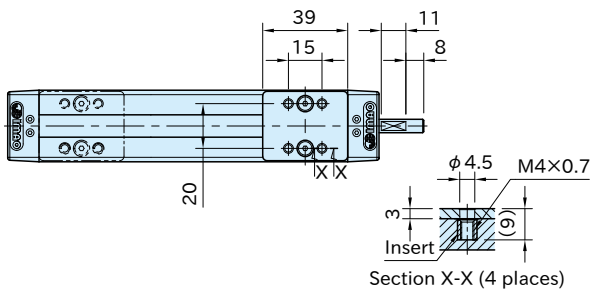

4-M3x0.5 Depth 5

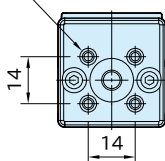

Dimensions of End Plate (Both ends)

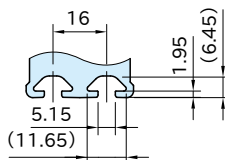

Dimensions of Slots

Part Number	Rotative Direction	S	LB	Weight (kg)
MAU3222SS-050R	CW	50	117	0.19
MAU3222SS-050L	CCW			
MAU3222SS-100R	CW	100	167	0.26
MAU3222SS-100L	CCW			

Related Product

Choose the optional elements for your needs.

- Shaft Locks
- Digital Position Indicators
- Pointer
- Scales
- Adapter Shafts
- Handwheels
- T-Nuts

How To Use

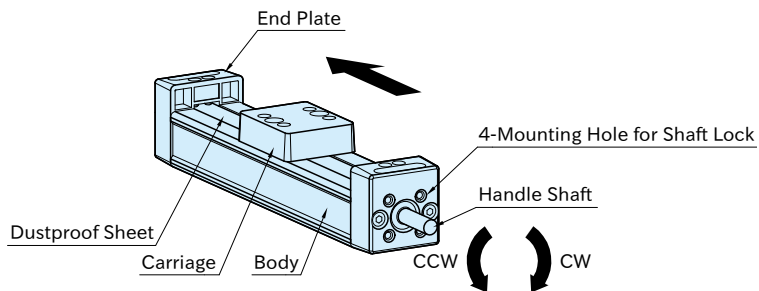

- **MAU3222SS-R** : Carriage moves toward the arrow direction by turning the Handle Shaft clockwise.
- **MAU3222SS-L** : Carriage moves toward the arrow direction by turning the Handle Shaft counterclockwise.
- Carriage moves 1mm per rotation of the Handle Shaft.

■ Horizontal Use

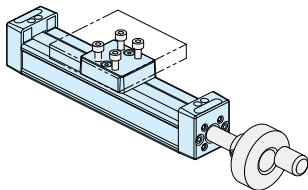

■ Vertical Use

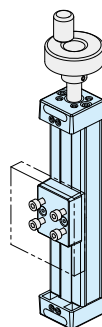

Reference

Technical Information of Mechanical Linear Actuators