

QLCCS

COMPACT CAM HANDLES

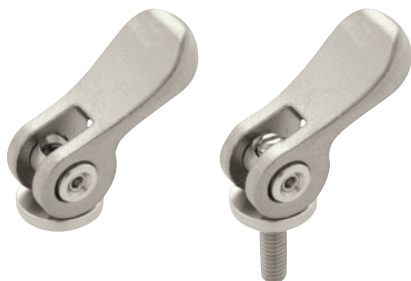

★ **Key Point** —
Easy clamping and unclamping.

Handle	Ring Nut / Stud	Washer
SCS13 stainless steel (Equivalent to SUS304)	SUS303 stainless steel	SUS304 stainless steel

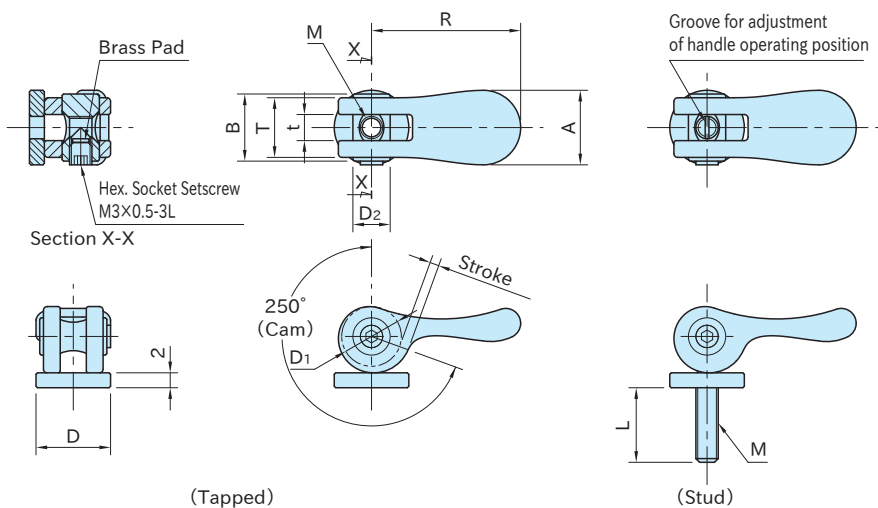

Size		D ₁	R	A	D	M	T	t	B	D ₂
QLCCS	03	8	20	10	10	M3×0.5	8	3.5	9	5
	04	10	25	13	12	M4×0.7	10	4.5	11	6
	05	12	32	16	14	M5×0.8	12	5.5	13	8

Size		Clamping Stroke	Allowable Operating Load (N)	Clamping Force (N)	Clamping Mechanism
QLCCS	03	1.2	30	400	Spiral Cam Cam Angle : 4°
	04	1.5	40	500	
	05	1.8	50	700	

QLCCS (Tapped)

Part Number	Weight (g)
QLCCS-03	7
QLCCS-04	13
QLCCS-05	23

QLCCS (Stud)

Part Number	L	Weight (g)
QLCCS-03×10	10	8
QLCCS-03×15	15	
QLCCS-04×15	15	16
QLCCS-04×20	20	
QLCCS-04×30	30	17
QLCCS-04×40	40	18
QLCCS-05×20	20	28
QLCCS-05×30	30	30
QLCCS-05×40	40	31
QLCCS-05×50	50	33

Feature

The handle position of Stud-type Compact Cam Handles can be set to a desired direction.

How To Use

■ Application Example

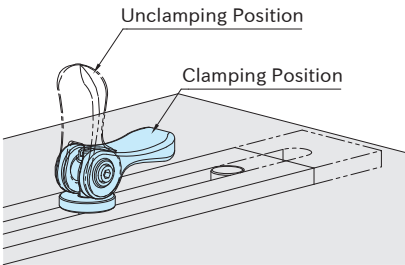

■ Fixing the Cam Handle

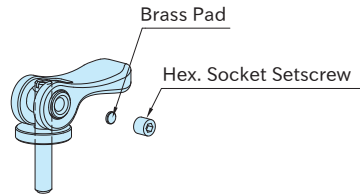

Use a brass pad and a hex. socket setscrew included to fix the handle.

■ How to Mount Stud-type Cam Handles

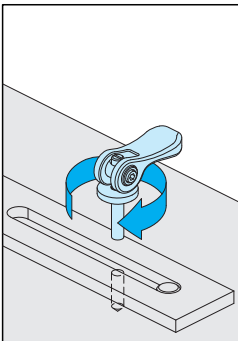

1. Fix the stud to the handle with a brass pad and a hex socket setscrew and screw the Compact Cam Handle to the counterpart.

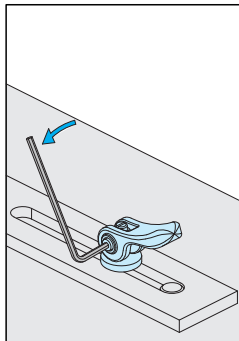

2. Turn the handle to a desired direction and loosen the setscrew.

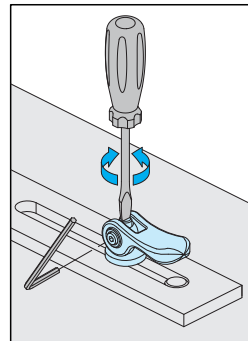

3. With a flathead screwdriver, adjust the handle to a desired clamping height and the load to fold the handle. Then fix the stud with the setscrew.