

BJ156-B

TAPPED-RADIUS CLAMP ASSEMBLIES, B Type

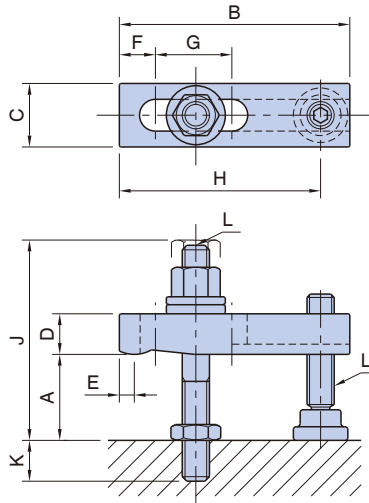

[Stud]

Material : SCM435 steel
 Heat Treat : Quenched and tempered
 Finish : Black oxide

[Others]

Material : S45C steel
 Heat Treat : Quenched and tempered
 Finish : Black oxide

Part Number	A	B	C	D	E	F	G	H	J	K	L	Clamping Force (N) At Max. - Min. End Projection	Allowable Screw Torque (N·m)	Weight (kg)		
									Max.							
BJ156-08050B1	20 - 35	50							64	16		4,000 - 7,600		0.14		
BJ156-08050B2	35 - 55								81	20					0.15	
BJ156-08050B3	60 - 75								105	20						0.17
BJ156-08063B1	20 - 35	63	19	12	5	12	27	55	64	16	M 8x1.25	3,100 - 8,300	17	0.15		
BJ156-08063B2	35 - 55								81	20					0.16	
BJ156-08063B3	60 - 75								105	20						0.18
BJ156-08080B1	15 - 35	80		16		15	34	72	65	16		3,400 - 8,400		0.2		
BJ156-08080B2	30 - 50								80	20					0.21	
BJ156-08080B3	55 - 75								105	20						0.23
BJ156-10063B1	25 - 50	63		12			18	53	80	20		6,400 - 12,200	34	0.25		
BJ156-10063B2	50 - 80								109						20	0.28
BJ156-10080B1	25 - 50	80	25	16	5	15	32	70	83	20	M10x1.5	7,400 - 17,700	45	0.3		
BJ156-10080B2	50 - 75								108						20	0.34
BJ156-10100B1	20 - 45								100						19	
BJ156-10100B2	45 - 75	111	20	0.45												

Part Number	A	B	C	D	E	F	G	H	J	K	L	Clamping Force (N) At Max. - Min. End Projection	Allowable Screw Torque (N·m)	Weight (kg)	
									Max						
BJ156-12063B1	25 - 50	63	32	16	6	14	14	52	86	18	M12x1.75	13,700 - 21,600	71	0.39	
BJ156-12063B2	50 - 70								107					0.43	
BJ156-12063B3	80 - 105								141					0.49	
BJ156-12080B1	25 - 50	80				19	20	50	114	86		18		10,300 - 21,000	0.43
BJ156-12080B2	50 - 70									107					0.47
BJ156-12080B3	80 - 105									141					0.53
BJ156-12100B1	20 - 45	100	19	20	40	89	84	18	10,900 - 25,800	0.57					
BJ156-12100B2	45 - 70						109			0.63					
BJ156-12100B3	75 - 100						139			0.64					
BJ156-12125B1	20 - 45	125	25	6	60	149	84	18	12,900 - 27,500	0.64					
BJ156-12125B2	45 - 70						109			0.68					
BJ156-12125B3	75 - 100						139			0.74					
BJ156-12160B1	15 - 40	160	38	25	6	65	85	18	17,400 - 32,500	0.96					
BJ156-12160B2	40 - 65						110			1					
BJ156-12160B3	70 - 95						140			1.06					
BJ156-16080B1	40 - 60	80	19	6	18	17	106	24	16,600 - 26,000	1.18					
BJ156-16080B2	65 - 90						136			1.33					
BJ156-16080B3	95 - 130						176			1.47					
BJ156-16100B1	35 - 60	100	22	6	30	85	109	24	12,700 - 25,300	1.35					
BJ156-16100B2	60 - 90						139			1.5					
BJ156-16100B3	95 - 125						174			1.64					
BJ156-16125B1	35 - 55	125	25	6	25	45	107	24	14,700 - 31,100	1.52					
BJ156-16125B2	60 - 90						142			1.67					
BJ156-16125B3	90 - 125						177			1.81					
BJ156-16160B1	35 - 55	160	38	25	65	145	107	24	15,300 - 33,400	1.71					
BJ156-16160B2	60 - 90						142			1.86					
BJ156-16160B3	90 - 125						177			2					