

QLCA

CAM HANDLES



(Tapped)

QLCA

(Black Oxide Finish)



(Stud)



(Tapped)

QLCA-NP

(Electroless Nickel Plated)



(Stud)

Style	Handle	Ring Nut / Washer	Stud
QLCA	SCM440 steel Quenched and tempered Black Oxide Finish	S45C steel Quenched and tempered Black Oxide Finish	SCM435 steel Quenched and tempered Black Oxide Finish
QLCA-NP	SCM440 steel Quenched and tempered Electroless Nickel Plated	S45C steel Quenched and tempered Electroless Nickel Plated	SCM435 steel Quenched and tempered Electroless Nickel Plated

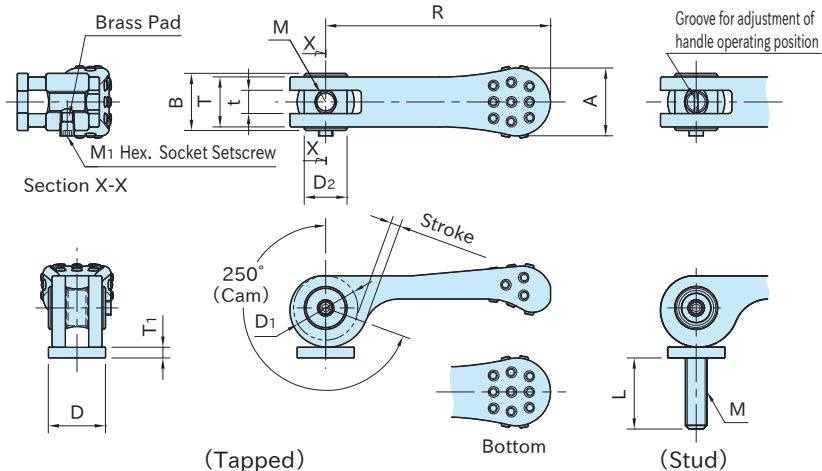

(Tapped)

Bottom

(Stud)

Size	D ₁	R	A	D	T ₁	M	T	t	B	D ₂	M ₁
QLCA	04	12	40	14	12	M 4×0.7	10	4.5	12	8	M3×0.5-3L
	05	15	50	16	14	M 5×0.8	12	5.5	14	10	
QLCA-NP	06	18	63	19	16	M 6×1	14	6.5	16	12	M4×0.7-4L
	08	22	80	24	20	M 8×1.25	18	9	20	15	
	10	28	100	30	25	M10×1.5	23	11	25	18	

Size	Clamping Stroke	Allowable Operating Load (N)	Clamping Force (kN)	Clamping Mechanism
QLCA	04	1.8	80	Spiral Cam Cam Angle : 4°
	05	2.3	100	
QLCA-NP	06	2.7	150	
	08	3.3	200	
	10	4.3	300	

QLCA QLCA-NP (Tapped)

Black Oxide Finish	Electroless Nickel Plated	Weight (g)
Part Number	Part Number	
QLCA-04	QLCA-04-NP	26
QLCA-05	QLCA-05-NP	46
QLCA-06	QLCA-06-NP	80
QLCA-08	QLCA-08-NP	154
QLCA-10	QLCA-10-NP	318

QLCA QLCA-NP (Stud)

Black Oxide Finish	Electroless Nickel Plated	L	Weight (g)
Part Number	Part Number		
QLCA-04×15	QLCA-04×15-NP	15	28
QLCA-04×20	QLCA-04×20-NP	20	29
QLCA-04×30	QLCA-04×30-NP	30	30
QLCA-04×40	QLCA-04×40-NP	40	31
QLCA-05×20	QLCA-05×20-NP	20	51
QLCA-05×30	QLCA-05×30-NP	30	52
QLCA-05×40	QLCA-05×40-NP	40	54
QLCA-05×50	QLCA-05×50-NP	50	55
QLCA-06×20	QLCA-06×20-NP	20	89
QLCA-06×30	QLCA-06×30-NP	30	91
QLCA-06×40	QLCA-06×40-NP	40	93
QLCA-06×50	QLCA-06×50-NP	50	96
QLCA-08×25	QLCA-08×25-NP	25	176
QLCA-08×30	QLCA-08×30-NP	30	178
QLCA-08×40	QLCA-08×40-NP	40	182
QLCA-08×50	QLCA-08×50-NP	50	186
QLCA-10×25	QLCA-10×25-NP	25	351
QLCA-10×30	QLCA-10×30-NP	30	354
QLCA-10×40	QLCA-10×40-NP	40	360
QLCA-10×50	QLCA-10×50-NP	50	366

Feature

The handle position of Stud-type Cam Handles can be set to a desired direction.

How To Use

Application Example

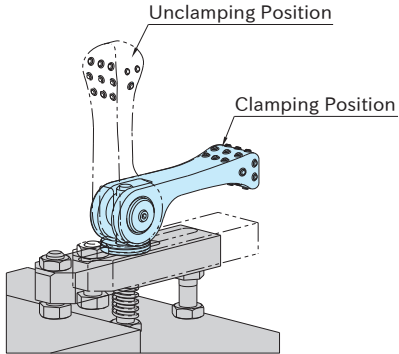

Fixing the Cam Handle

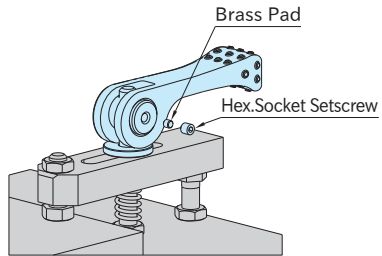

Use a brass pad and a hex. socket setscrew included.

How to Mount Stud-type Cam Handles

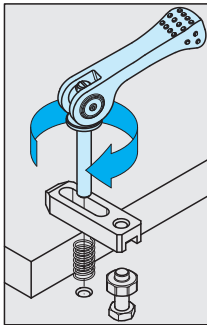

1. Fix the stud to the handle with a brass pad and a hex socket setscrew and screw the Cam Handle to the counterpart.

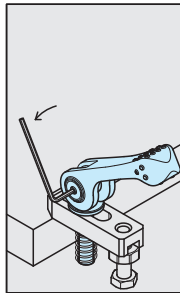

2. Turn the handle to a desired direction and loosen the setscrew.

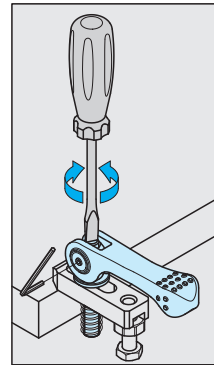

3. With a flathead screwdriver, adjust the handle to a desired clamping height and the load to fold the handle. Then fix the stud with the setscrew.