

CP166-H

CLAMPING SCREWS (Hook)

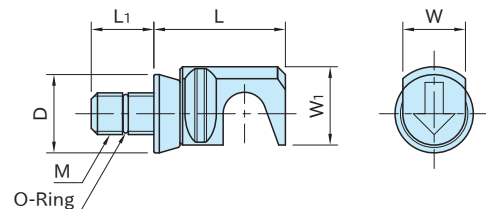

Tapered Bushing	Clamping Screw	O-Ring
S45C steel Black oxide finished	SCM435 steel Quenched and tempered Black oxide finished	Nitrile rubber (NBR)

Part Number	M	L ₁	D	L	W ₁	W	Proper O-Ring Size	Weight (g)	Proper Clamping Module
CP166-08001H	M 8×1.25	12	15	25	15	12	SS050(CS1 /ID 5)	26	CP160-08040R,CP160-08040L
CP166-12001H	M12×1.75	18	24	40	23.5	19	S 8 (CS1.5/ID 7.5)	103	CP160-12063R,CP160-12063L
CP166-16001H	M16×2	22	31	51	30	24	S 12 (CS1.5/ID11.5)	213	CP160-16080R,CP160-16080L

Reference

Feature and How To Use in later page